

5.2 Mail-Level Backup and Restore for Exchange Server DAG thru a Remote Machine

5.2.1 Create Mail Level Backup Set

Follow this section if your AhsayOBM is installed on a remote machine.

5.2.1.1. Click the Backup Sets icon on the main interface of AhsayOBM.



5.2.1.2. Create a new backup set by clicking the "+" icon next to Add new backup set.

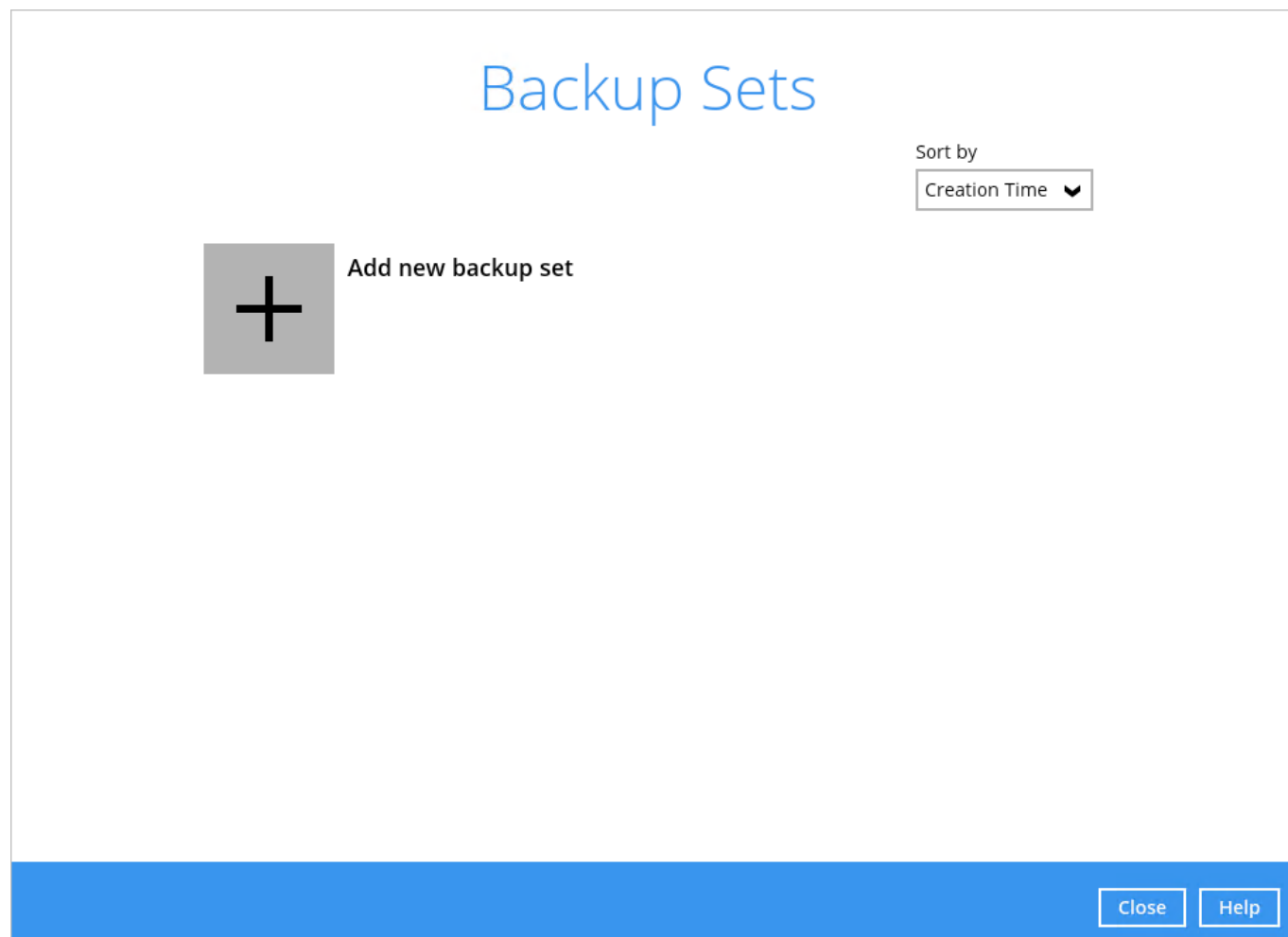

5.2.1.3. Select the Backup set type as MS Exchange Mail Level Backup.

Create Backup Set

Name

MS Backup 2019 Mail Level Backup (DAG)

Backup set type

MS Exchange Mail Level Backup

Version

Microsoft Exchange Server 2007
Microsoft Exchange Server 2007
Microsoft Exchange Server 2010
Microsoft Exchange Server 2013
Microsoft Exchange Server 2016
Microsoft Exchange Server 2019
Microsoft Exchange Server 2010 (DAG)
Microsoft Exchange Server 2013 (DAG)
Microsoft Exchange Server 2016 (DAG)

Next

Cancel

Help

- Name your new backup set.
- Select from the following version:
 - Microsoft Exchange Server 2013
 - Microsoft Exchange Server 2016
 - Microsoft Exchange Server 2019
 - Microsoft Exchange Server 2013 (DAG)
 - Microsoft Exchange Server 2016 (DAG)
 - Microsoft Exchange Server 2019 (DAG)
- As AhsayOBM is not installed directly on the MS Exchange 2016 or 2019 server, it cannot automatically detect the MS Exchange version. Therefore, the MS Exchange version must be selected manually.

Create Backup Set

Name

MS Exchange 2019 Mail Level Remote Backup (DAG)

Backup set type

 MS Exchange Mail Level Backup ▼

Version

Microsoft Exchange Server 2019 (DAG) ▼

Host (DAG Member Server)

IP address of DAG Member Server

X

IP address of DAG Member Server

X

Add

Username

username

Password

••••••••

☐ Access the Internet through proxy

Test

Next

Cancel

Help

- Enter the hostname of Exchange server, the username and password of the Windows user account used for backup.
- Check the “Access the Internet through proxy” if required.
- Click the Test button to verify the login details..
- Then click Next to proceed.

5.2.1.4. In the Backup Source menu, select the mailboxes or public folders for backup. You can click to expand the according mailbox or public folder to select which mail folder to back up. You can also click Show mails to select individual mail to back up. Click Next to proceed when you are done.

Backup Source

Folders

10.90.6.81

Mailboxes

Administrator@xch16dag

backup@xch16dag

Inbox

Drafts

Sent Items

Deleted Items

Calendar

Contacts

Junk Email

Notes

Tasks

user01@xch16dag

user02@xch16dag

user03@xch16dag

| To | Subject | Sent | Size |
|---|-------------------------|------------------|------|
| <input checked="" type="checkbox"/> Administrator | Delivering Health Ca... | 05/03/2019 10:34 | 4k |
| <input checked="" type="checkbox"/> Administrator | How technology is c... | 05/03/2019 09:10 | 6k |
| <input checked="" type="checkbox"/> Administrator | Login to User Mailbox | 04/03/2019 16:43 | 11k |
| <input checked="" type="checkbox"/> Administrator | Create User Mailbox... | 04/03/2019 16:39 | 10k |

☒ Show mails

Items per page 50

Page 1 / 1

[Previous](#)[Next](#)[Cancel](#)[Help](#)

5.2.1.5. In the Schedule menu, you can configure a backup schedule for backup job to run automatically at your specified time interval. By default, the Run scheduled backup for this backup set option is disabled. Enable it then click the “+” icon next to Add new schedule. Click Next to proceed when you are done setting.

Schedule

Run scheduled backup for this backup set

off ☐

PreviousNextCancelHelp

5.2.1.6. In the Destination menu, select a backup destination where the backup mail will be stored. Click the “+” icon next to Add new storage destination / destination pool.

Destination

Backup mode

Sequential ▼

Existing storage destinations

+ Add new storage destination / destination pool

^ v

Previous Next Cancel Help

5.2.1.7. Select the destination storage, then click OK to proceed.

New Storage Destination / Destination Pool

Name

AhsayCBS

Destination storage

AhsayCBS ▼

OK Cancel Help

5.2.1.8. Click Next on the Destination menu page to proceed.

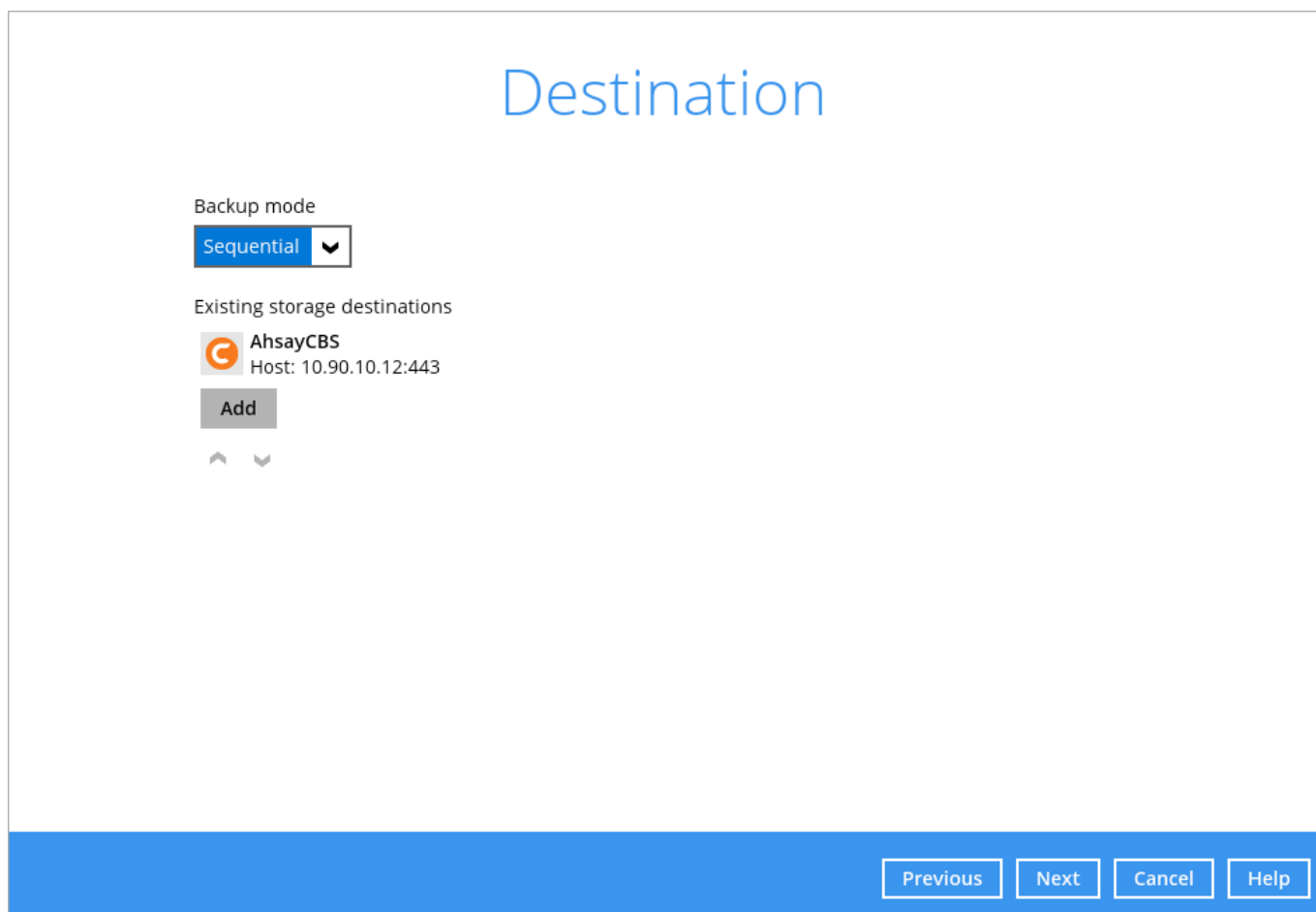

The 'Destination' window is titled 'Destination' in large blue font. It contains a 'Backup mode' dropdown menu set to 'Sequential'. Below this is a section for 'Existing storage destinations' which lists 'AhsayCBS' with host '10.90.10.12:443'. There is an 'Add' button and up/down arrow icons. At the bottom right, there are four buttons: 'Previous', 'Next', 'Cancel', and 'Help'.

5.2.1.9. In the Encryption window, the default Encrypt Backup Data option is enabled with an encryption key preset by the system which provides the most secure protection.

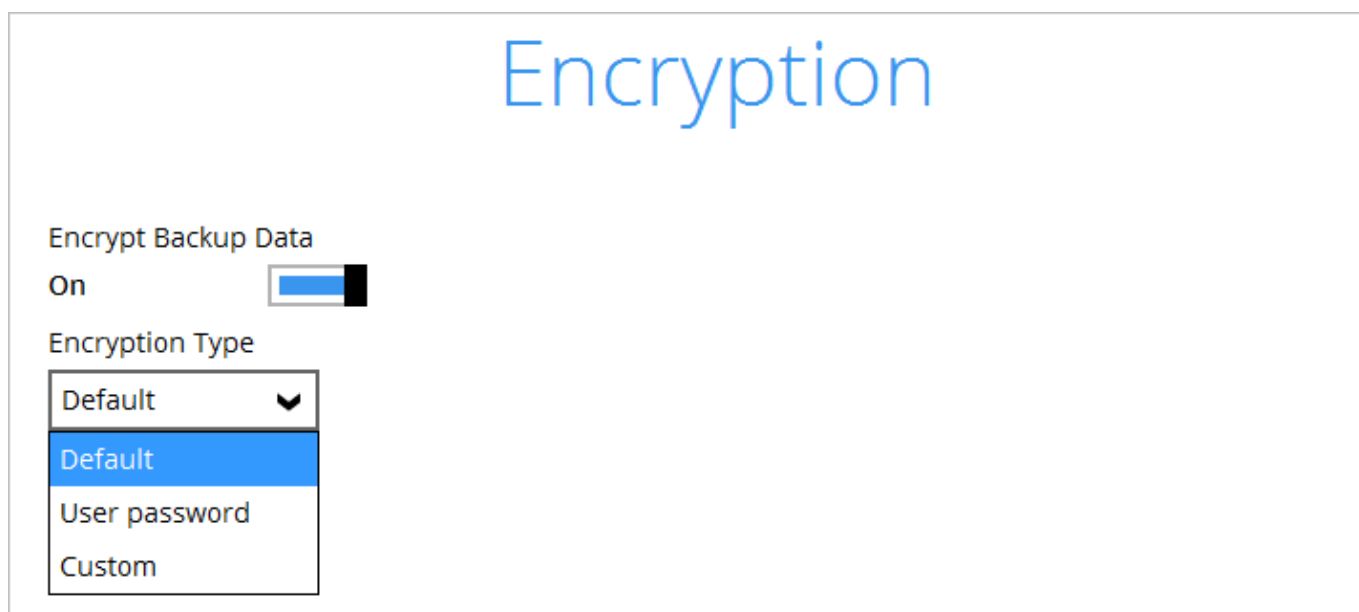

The 'Encryption' window is titled 'Encryption' in large blue font. It features an 'Encrypt Backup Data' toggle switch set to 'On'. Below this is the 'Encryption Type' dropdown menu, which is currently open and shows three options: 'Default' (selected), 'User password', and 'Custom'.

5.2.1.10. You can choose from one of the following three Encryption Type options:

- **Default** – an encryption key with 44 alpha numeric characters will be randomly generated by the system
- **User password** – the encryption key will be the same as the login password of your AhsayOBM

at the time when this backup set is created. Please be reminded that if you change the AhsayOBM login password later, the encryption keys of the backup sets previously created with this encryption type will remain unchanged.

- **Custom** - you can customize your encryption key, where you can set your own algorithm, encryption key, method and key length.



5.2.1.11. If you have enabled the Encryption Key feature in the previous step, the following pop-up window shows, no matter which encryption type you have selected.

The screenshot shows a dark-themed window titled "Encryption". It has two sections. The top section, "Encrypt Backup Data", has a toggle switch set to "On" and a dropdown menu for "Encryption Type" showing "User password". The bottom section has a blue background with white text: "You are advised to write this encryption key down on paper and keep it in a safe place. You will need it when you need to restore your files later. Please confirm that you have done so." Below this is a text input field containing six dots. A link "Unmask encryption key" is below the field. At the bottom right are two buttons: "Copy to clipboard" and "Confirm".

The pop-up window has the following three options to choose from:

- **Unmask encryption key** - The encryption key is masked by default. Click this option to show the encryption key.
- **Copy to clipboard** - Click to copy the encryption key, then you can paste it in another location of your choice.
- **Confirm** - Click to exit this pop-up window and proceed to the next step



5.2.1.12. Enter the Windows login credentials for user authentication. Click Next to proceed. The User name should be entered in the following format "user@hostname", i.e. administrator@ahsay.com



The Windows User Authentication interface will show only if scheduled backup is enabled and set successfully.

5.2.1.13. The following screen shows when the new backup set is created successfully.

Congratulations!

"MS Exchange 2016 Mail Level Remote Backup (DAG)" is succes...

[Backup now](#)[Close](#)

5.2.1.14. Click Backup now to start a backup immediately, or you can run a backup job later by following the instructions in Run Mail Level Backup Job

5.2.2 Run Mail Level Backup Job



Below are the steps of the backup process.

5.2.2.1. Log in to AhsayOBM.

5.2.2.2. Click the Backup icon on the main interface of AhsayOBM.



5.2.2.3. Select the backup set which you would like to start a backup for.

Please Select The Backup Set To Backup

Sort by

Creation Time ▼



MS Exchange 2016 Mail Level Remote Backup (DAG)

Owner: DESKTOP-I7U6970

Newly created on Wednesday, 6 March 2019 09:24

Close

Help

5.2.2.4. If you would like to modify the In-File Delta type, Destinations and Retention Policy settings, click Show advanced option.

{{public:documents_and_guides:obm:exchange-mail-level-backup-ews:image311.png?800}}

5.2.2.5. Click Backup to start the backup.

5.2.3 Restore Mail Level Backup



Below are the steps of the restore process.

5.2.3.1. In the AhsayOBM main interface, click the Restore icon.



5.2.3.2. Select the backup set that you would like to restore mail from.

Please Select The Backup Set To Restore

Sort by

Creation Time ▼



MS Exchange 2016 Mail Level Remote Backup (DAG)

Owner: DESKTOP-I7U6970

Last Backup: Wednesday, 6 March 2019 09:44

Close

Help

5.2.3.3. Select the backup destination that contains the mail(s) that you would like to restore.

Select The Destination From Which To Restor...



MS Exchange 2016 Mail Level Remote Backup (DAG)



AhsayCBS

Host: 10.90.10.12:443

Previous

Cancel

Help

5.2.3.4. Click to expand the menu tree to select which mailbox to restore. You can also select mail item(s) from a specific backup job or all mail items that you have backed up to restore. Click Next to proceed.

Select Your Mail Objects To Be Restored

Select what to restore

Choose from files as of job ▼

06/03/2019 ▼

Latest ▼

Show filter

| Folders | Subject | Date modified | Size |
|--|---------|---------------|------|
| <div><div><div>AhsayCBS</div><div><div>10.90.6.81</div><div><div>Mailboxes</div><div><div>backup@xch16</div></div></div></div></div></div> | | | |

Search

Items per page 50 ▼

Page - ▼

Previous

Next

Cancel

Help

5.2.3.5. Select to restore the mail to their Original location, Alternate location or to an Alternate host.

- **Restore to Original Location** - Select the **Original location** option. If you would like to modify the Verify checksum of in-file delta files setting, click **Show advanced option**. Then press **Next** to proceed.

Choose Where The Mail Objects To Be Restor...

Restore mail objects to

☒ Original location

☐ Alternate location

☐ Alternate host

[Show advanced option](#)

Previous

Next

Cancel

Help

Choose Where The Mail Objects To Be Restor...

Restore mail objects to

☒ Original location

☐ Alternate location

☐ Alternate host

☐ Verify checksum of in-file delta files during restore

[Hide advanced option](#)

Previous

Next

Cancel

Help

- **Restore to Alternate Mailbox** - You can choose to restore mailbox item(s) to another mailbox in the same Exchange server. Select the **Alternate location** option. If you would like to modify the Verify checksum of in-file delta files setting, click **Show advanced option** then press **Next**. Select the desired mailbox destination, then press Next to proceed.

Choose Where The Mail Objects To Be Restor...

Restore mail objects to

☐ Original location

☒ Alternate location

☐ Alternate host

[Show advanced option](#)

Previous

Next

Cancel

Help

Alternate Location

Host

10.16.6.81

10.16.6.82

User

Administrator@xch16dag.ahsay.com

Administrator@xch16dag.ahsay.com

backup@xch16dag.ahsay.com

user01@xch16dag.ahsay.com

user02@xch16dag.ahsay.com

user03@xch16dag.ahsay.com

Previous

Next

Cancel

Help

- **Restore to Alternate Host** - You can also choose to restore mailbox item(s) to another mailbox in another Exchange server of the same version. Select the **Alternate host** option. Enter the host, username and password of the alternate Exchange server. If you will access the internet through proxy, check the box beside it and set the configuration for the proxy server

and click Save. If you would like to modify the Verify checksum of in-file delta files setting, click **Show advanced option**.

Choose Where The Mail Objects To Be Restor...

Restore mail objects to

- ☐ Original location
☐ Alternate location
☒ Alternate host

Host

10.16.6.81

Username

backup

Password

•••••

☐ Access the Internet through proxy

Test

Show advanced option

Previous

Next

Cancel

Help

Proxy (HTTP)

IP address

Port

Login ID

Password

Test connection

Save

Cancel

Select the desired mailbox destination then press Next proceed.

Alternate Location

Host

User

Administrator@xch16dag.ahsay.com ▼

Administrator@xch16dag.ahsay.com

backup@xch16dag.ahsay.com

user01@xch16dag.ahsay.com

user02@xch16dag.ahsay.com

user03@xch16dag.ahsay.com

Previous

Next

Cancel

Help

Please refer to the [Limitation](#) part to check for the limitation of the restore process.

5.2.3.6. Select the temporary directory for storing temporary files, such as delta files when they are being merged, click Restore to start the restoration.

Temporary Directory

Temporary directory for storing restore files

5.2.3.7. The following screen with the text Restore Completed Successfully shows when the restoration is completed.

Restore



MS Exchange 2016 Mail Level Remote Backup (DAG)



AhsayCBS (Host: 10.90.10.12:443)

✓ Restore Completed Successfully

Estimated time left 0 sec

Restored 0 (0 file)

Elapsed time 14 sec

Transfer rate 0bit/s



Close

Help

From:
<https://wiki-new.ahsay.com/> - Ahsay Wiki

Permanent link:
https://wiki-new.ahsay.com/doku.php?id=public:documents_and_guides:v8:obm:exchange-mail-level-backup-ews:backup-restore-on-remote-machine-dag

Last update: 2020/05/04 18:33

